

PRK 25B

Retro-reflective photoelectric sensors with polarisation filter

en 04-2011/09 50108917-01



0.05 ... 10m



- Polarised retro-reflective photoelectric sensor with visible red light
- High performance reserve
- Small and compact construction with robust plastic housing, protection class IP 66/IP 67 for industrial application
- Fast alignment through *brightVision*®
- A²LS - Active Ambient Light Suppression
- Push-pull switching outputs
- High switching frequency for detection of fast events
- Parallel connection of switching outputs
- Warning output for increased availability
- Operating range adjustment

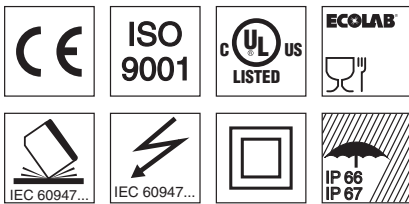

Accessories:

(available separately)

- Mounting systems (BT 25, UMS 25...)
- Cable with M8 or M12 connector (K-D ...)
- Reflectors
- Reflective tapes

Dimensioned drawing

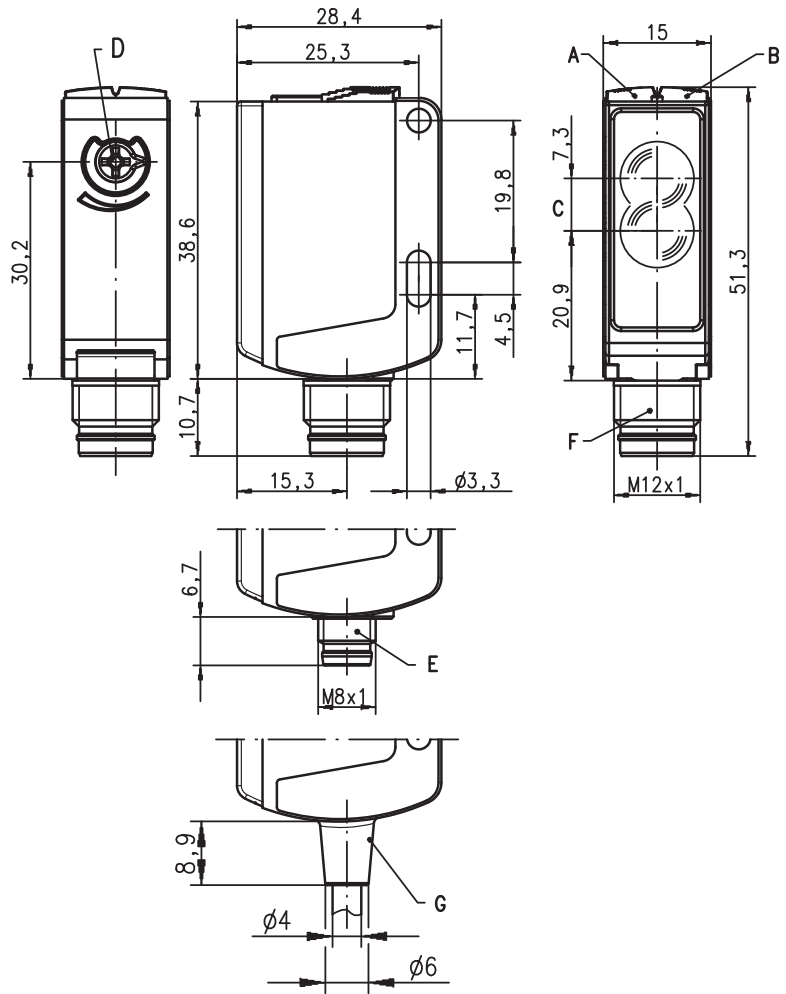

- A Green indicator diode
- B Yellow indicator diode
- C Optical axis
- D Operating range adjustment
- E Connector M8x1
- F Connector M12x1
- G Cable

Electrical connection

PRK 25B/66-S8
PRK 25B/66-S12
PRK 25B/66, 200-S12
PRK 25B/66.1-S12

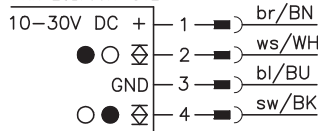

PRK 25B/66

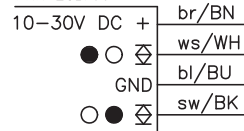

PRK 25B/4.8-S12

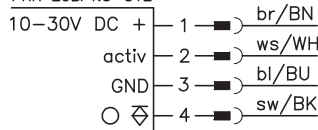

IPRK 25B/4-S12
IPRK 25B/4, 200-S12

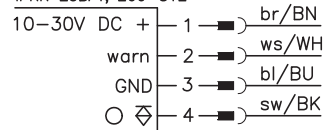

PRK 25B/44-S12

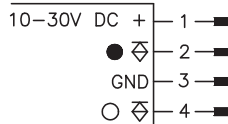

We reserve the right to make changes • DS_PRK25B_4_66_b01_en.fm

Specifications

Optical data

Typ. op. range limit (TK(S) 100x100) ¹⁾	0.05 ... 10m
Operating range ²⁾	see tables
Light source ³⁾	LED (modulated light)
Wavelength	620nm (visible red light, polarised)

Timing

Switching frequency	500Hz
Response time	1ms
Delay before start-up	≤ 300ms

Electrical data

Operating voltage U_B ⁴⁾	10 ... 30VDC (incl. residual ripple)
Residual ripple	≤ 15% of U_B
Open-circuit current	≤ 20mA
Switching output ⁵⁾	.../66 .../66.1 .../44 IPRK.../4 .../4.8
	2 push-pull switching outputs pin 2: PNP dark switching, NPN light switching pin 4: PNP light switching, NPN dark switching Pin 2: PNP dark switching pin 4: PNP light switching 1 PNP switching output light switching, 1 warning output 1 PNP switching output light switching, 1 activation input light/dark switching
Function characteristics	
Signal voltage high/low	$\geq (U_B - 2V) / \leq 2V$
Output current	max. 100mA
Operating range	fixed setting, adjustable with potentiometer for ".1 types"

Indicators

Green LED	ready
Yellow LED	light path free
Yellow LED, flashing	light path free, no performance reserve

Mechanical data

Housing	plastic (PC-ABS)
Optics cover	plastic (PMMA)
Weight	with connector: 15g with 200mm cable and connector: 30g with 2m cable: 55g
Connection type	cable 2m (cross section 4x0.21 mm ²), connector M8 or M12, cable 0.2m with connector M12

Environmental data

Ambient temp. (operation/storage)	-30°C ... +55°C / -30°C ... +60°C
Protective circuit ⁶⁾	2, 3
VDE safety class ⁷⁾	II
Protection class	IP 66, IP 67
LED class	1 (acc. to EN 60825-1)
Standards applied	IEC 60947-5-2
Certifications	UL 508 ⁴⁾

Options

Warning output autoControl warn	PNP transistor, counting principle
Signal voltage high/low	$\geq (U_B - 2V) / \leq 2V$
Output current	max. 100mA
Activation input activ	
Transmitter active/not active	$\geq 8V / \leq 2V$
Activation/disable delay	≤ 1ms
Input resistance	10KΩ ± 10%

- 1) Typ. operating range limit: max. attainable range without performance reserve
- 2) Operating range: recommended range with performance reserve
- 3) Average life expectancy 100,000h at an ambient temperature of 25°C
- 4) For UL applications: for use in class 2 circuits according to NEC only
- 5) The push-pull switching outputs must not be connected in parallel
- 6) 2=polarity reversal protection, 3=short-circuit protection for all transistor outputs
- 7) Rating voltage 50V

Tables

Reflectors			Operating range	
1	TK(S) 100x100		0.05 ... 8.0m	
2	TK(S) 40x60		0.05 ... 4.0m	
3	TK(S) 20x40		0.05 ... 2.5m	
1	0,05		8	10
2	0,05	4		5
3	0,05	2,5		3

Operating range [m]
 Typ. operating range limit [m]

TK ... = adhesive
 TKS ... = screw type

Diagrams

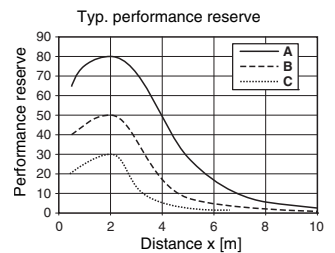
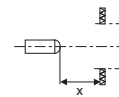
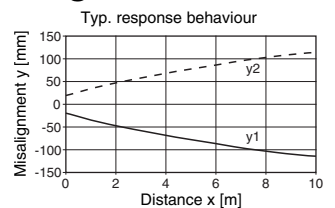

- A TK(S) 100x100
- B TK(S) 40x60
- C TK(S) 20x40

Remarks

- **Approved purpose:**
This product may only be used by qualified personnel and must only be used for the approved purpose. This sensor is not a safety sensor and is not to be used for the protection of persons.

PRK 25B
Retro-reflective photoelectric sensors with polarisation filter
Order guide

Selection table		PRK 25B/66-S12 Part No. 50104223	PRK 25B/66-S8 Part No. 50104224	PRK 25B/66 Part No. 50104225	PRK 25B/66, 200-S12 Part No. 50104226	PRK 25B/4.8-S12 Part No. 50104227	IPRK 25B/4-S12 Part No. 50104228	IPRK 25B/4, 200-S12 Part No. 50104229	PRK 25B/66.1-S12 Part No. 50104230	PRK 25B/44-S12 Part No. 50109432
Equipment ↓		Order code →								
Switching output	2 x Push-pull switching output	●	●	●	●				●	
	1 x PNP output					●				
	2 x PNP output						●	●		●
Switching function	1 PNP light switching and NPN dark switching output	●	●	●	●				●	
	1 PNP dark switching and NPN light switching output	●	●	●	●				●	
	1 x PNP dark switching output									●
	1 x PNP light switching output					●	●	●		●
	1 warning output						●	●		
Connection	M8 connector, 4-pin		●							
	M12 connector, 4-pin	●				●	●		●	●
	cable 2.000mm			●						
	cable 200mm with M12 connector, 4-pin				●			●		
Indicators	green LED: ready	●	●	●	●	●	●	●	●	●
	yellow LED: light path free	●	●	●	●	●	●	●	●	●
Options	operating range adjustment via potentiometer								●	
	 activation input					●				
	high performance reserve	●	●	●	●	●	●	●	●	●

